

Traversa T2

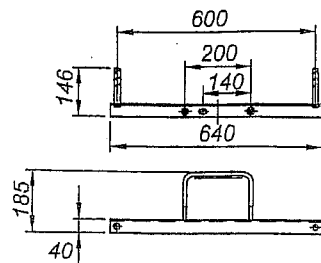

Apkabos A-1A; A-2A; A-3A

Traversa K2

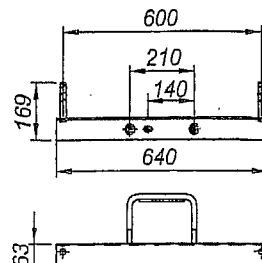

Apkabos A-4A; A-5A; A-6A

Traversa I2

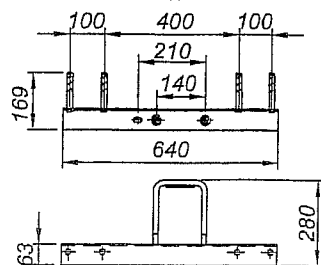

Apkabos A-4A; A-5A; A-6A

Ramsčio tv. mazgas PTM-1,1

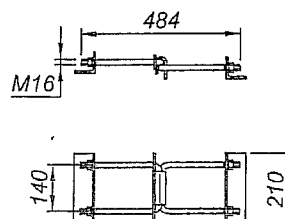

Atotampa A20-1,1

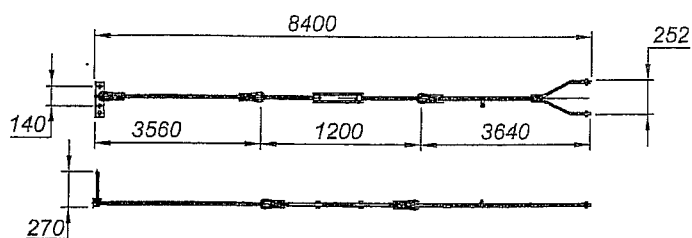

Apkaba A-4A; A-5A; A-6A (Ap16-2,7)

Atotampa A20-2,7

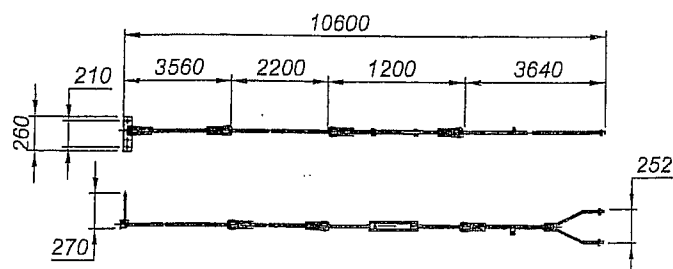

Apkaba Ap 16-2,7 (A-6A)

Apkaba Ap 12-235

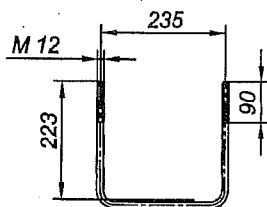

Ruošinio ilgis 681 mm

Apkaba Ap 12-265 (A-8)

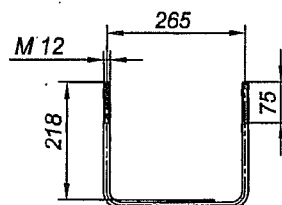

Ruošinio ilgis 715 mm

Gandalizdis GL-1

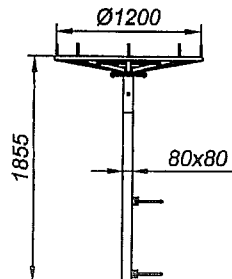

Apkabos Ap12-2,7

Gandalizdis GL-2

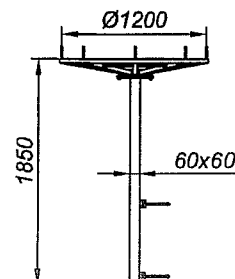

Apkabos Ap12-2,7

Įžeminimo laidininkas L-1

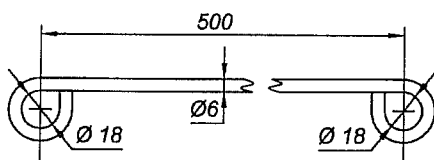

Įžeminimo laidininkas L-2

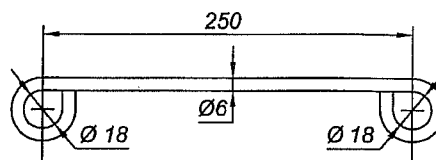

Įžeminimo laidininkas L-3

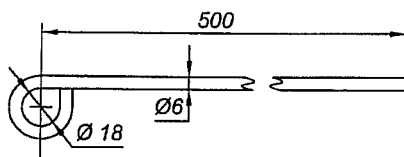

Traversa lk-1

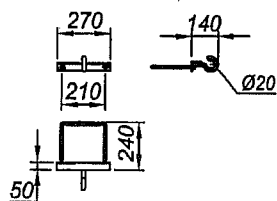

Apkaba Ap 16-2,7 (A-6A)

Traversa lk-1-1

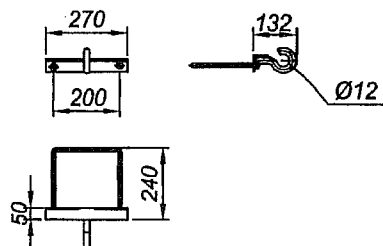

Apkabos: Ap 12-2,7 (A-3A); A-1A; A-2A

Traversa Tk-2

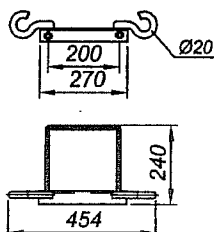

Apkaba Ap 12-2,7 (A-3A)

Traversa Tk-2-1

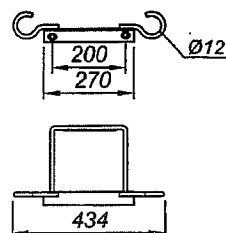

Apkabos: Ap 12-2,7 (A-3A); A-1A; A-2A

Traversa lk-2

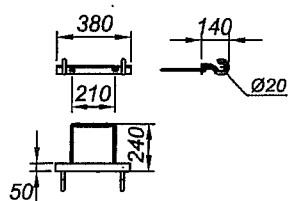

Apkaba Ap 16-2,7 (A-6A)

Traversa lk-2-1

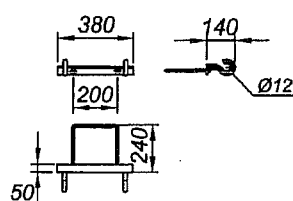

Apkaba Ap 12-2,7 (A-3A)

Traversa lk-4

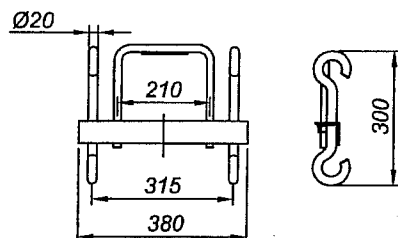

Apkaba AP16-2,7 (A-6A)

Traversa Tk-1-1

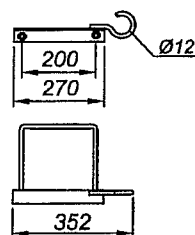

Apkabos: Ap 12-2,7 (A-3A); A-1A; A-2A

Kablų Kb-1 (SOT 15,9)

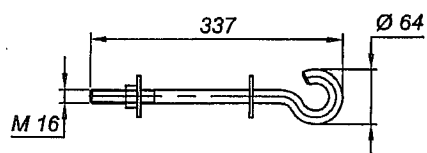

Kablų Kb-2

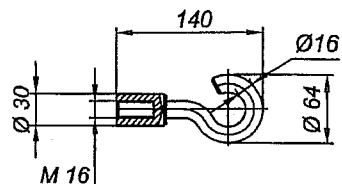

Kablų Kb-5

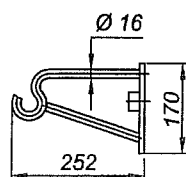

Kablų SK-1 (P-1)

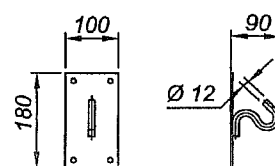

Reperis (kabelio žymeklis)

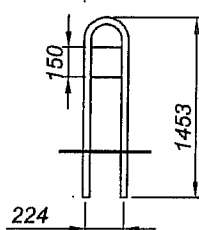

Jungiančioji kryžmė

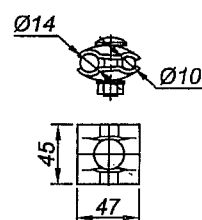

Apsauga nuo teršimo MK-1

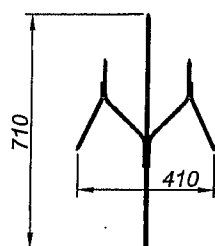

Traversa I10-2-1

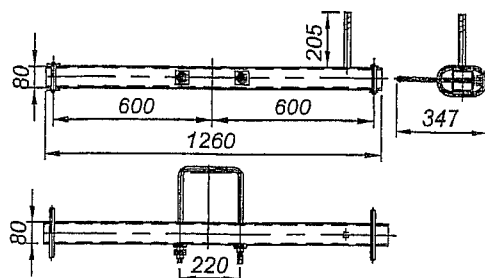

Apkaba Ap 16i-1

Viršįtampių ribotuvų laikiklis RLi

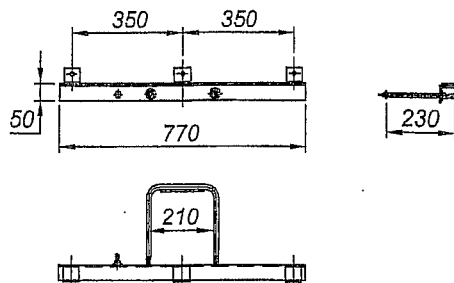

Apkaba Ap 16-2,7 (A-6A)

Izoliatoriaus laikiklis IL

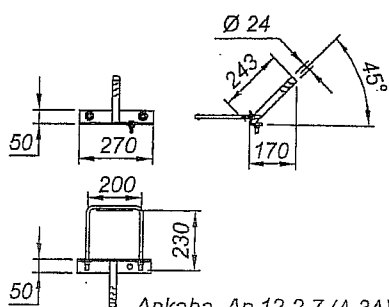

Apkaba Ap 12-2,7 (A-3A)

Gaubtas kabeliui GKi

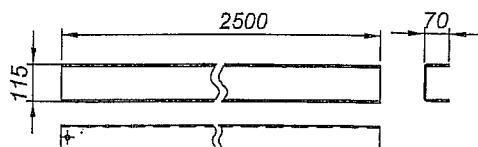

Apkabos Ap 12i-G

Ramsčio tv. mazgas PTM-2,7

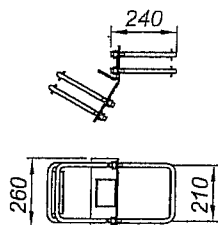

Apkabos Ap 16-2,7 (A-6A)

Apkaba AP 12i

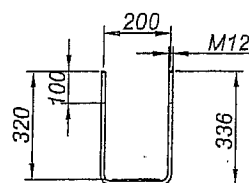

Ruošinio ilgis 850 mm

Apkaba gaubto tv. AP 12i-G

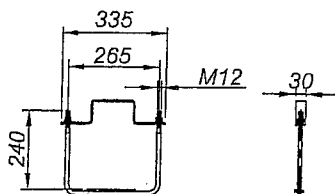

Apkaba AP 16i-1

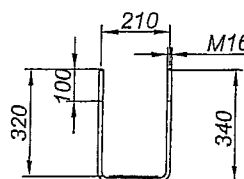

Ruošinio ilgis 857 mm

10 kV įtampos oro linijų neizoliuotais laidais metalo konstrukcijos Lapas

Įžeminimo laidininkai ŽLn

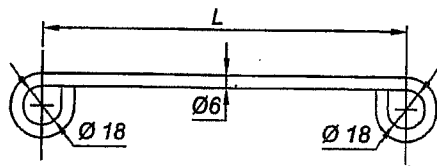

| Markė | L mm |
|-------|------|
| ŽLn-1 | 130 |
| ŽLn-2 | 215 |
| ŽLn-3 | 315 |
| ŽLn-4 | 410 |
| ŽLn-5 | 705 |
| ŽLn-6 | 805 |

| | |
|--------|------|
| ŽLn-7 | 905 |
| ŽLn-8 | 1005 |
| ŽLn-9 | 1105 |
| ŽLn-10 | 1125 |
| ŽLn-11 | 1205 |
| ŽLn-12 | 1705 |
| ŽLn-13 | 2405 |

Įžeminimo laidininkai L

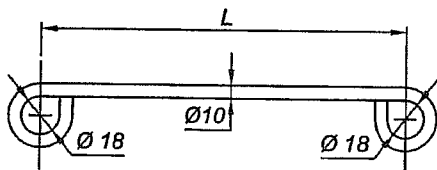

| Markė | L mm |
|--------|------|
| L-630 | 630 |
| L-930 | 930 |
| L-1000 | 1000 |
| L-1400 | 1400 |
| L-1800 | 1800 |
| L-3600 | 3600 |

Įžeminimo laidininkai ŽL

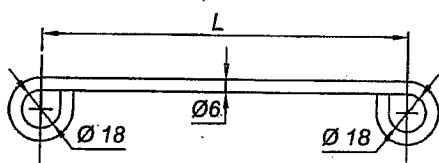

| Markė | L mm |
|-------|------|
| ŽL-1 | 310 |
| ŽL-2 | 370 |
| ŽL-3 | 140 |
| ŽL-4 | 430 |
| ŽL-6 | 200 |
| ŽL-10 | 560 |

Įžeminimo laidininkai ŽLi

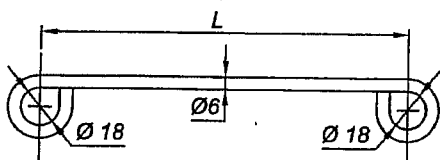

| Markė | L mm |
|-------|------|
| ŽLi-1 | 570 |
| ŽLi-2 | 340 |
| ŽLi-3 | 240 |
| ŽLi-4 | 640 |
| ŽLi-5 | 140 |
| ŽLi-6 | 1520 |
| ŽLi-7 | 2000 |
| ŽLi-8 | 370 |

| | |
|--------|------|
| ŽLi-9 | 1370 |
| ŽLi-10 | 1300 |
| ŽLi-11 | 1130 |
| ŽLi-12 | 970 |
| ŽLi-13 | 510 |
| ŽLi-14 | 1570 |
| ŽLi-15 | 3300 |
| ŽLi-16 | 2520 |

Įžeminimo laidininkai ŽLo

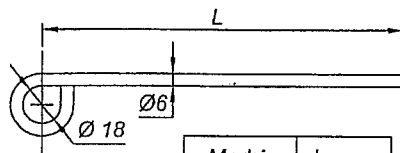

| Markė | L mm |
|-------|------|
| ŽLo-1 | 480 |
| ŽLo-2 | 550 |

Įžeminimo laidininkas ŽL-9

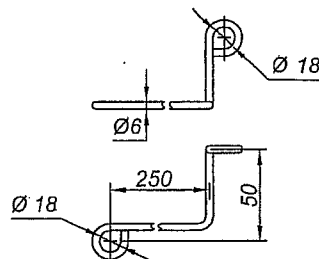

Ruošinio ilgis 480 mm

Traversa K1-2,7 (0,4 kV)

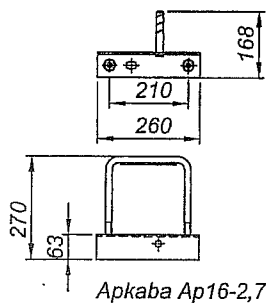

Apkaba Ap16-2,7

Traversa K1-1,1-1 (0,4 kV)

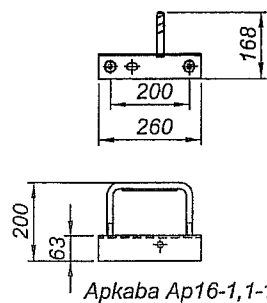

Apkaba Ap16-1,1-1

Rėmelis laido tv. RŠF-10

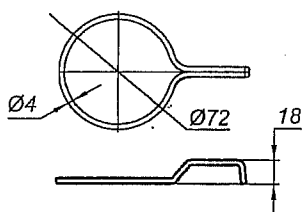

Rėmelis laido tv. RŠF-20

